

ENTERPRISE UI DESIGN SYSTEM

The Fiber Design System is an internal set of design standards, components and patterns that established the UI design and foundation for Samtec's internal web applications.

The UI library first addresses the design inconsistencies between applications.

Provides templates for designers and developers to rapidly move from mockups to production ready Angular components.

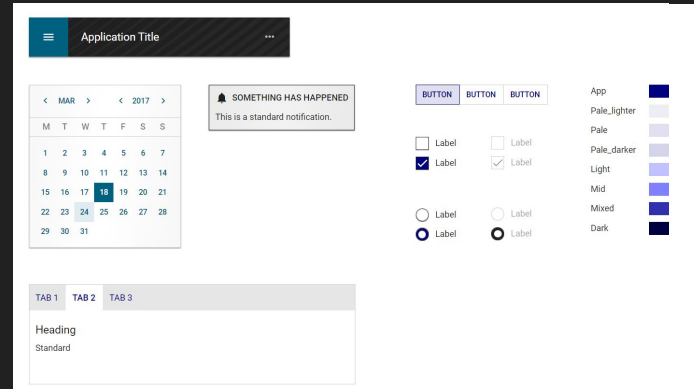

Example of reusable UI components from internal resources website

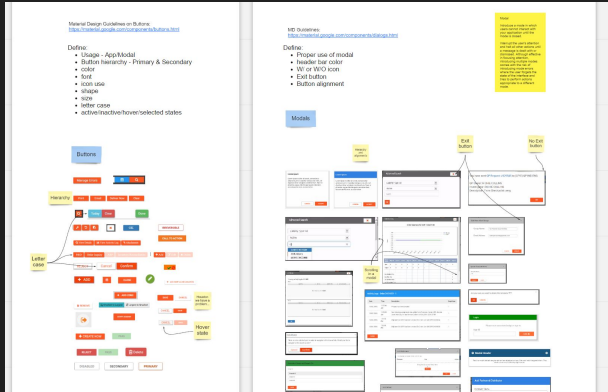

Inventory and categorization of components from web applications for reviewing inconsistencies

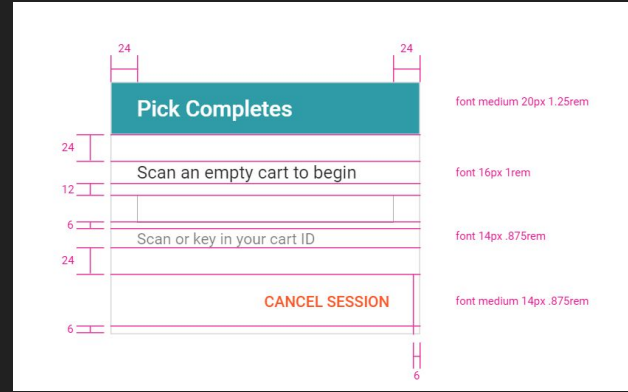

Example components built in Axure for the Design System Components

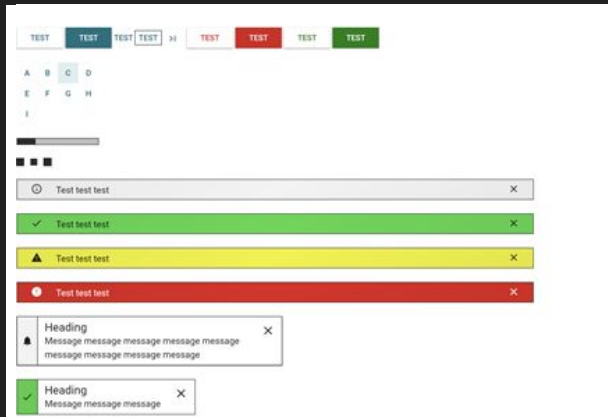

Example HTML/CSS components for Angular kits

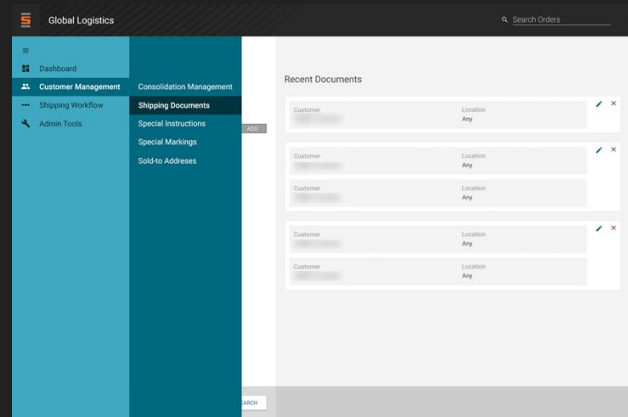

Rapid prototyping using UI component library